



25 Elm Park

Didcot, OX11 6DS

50% Shared Ownership £110,000

This well-presented second-floor apartment offers two bedrooms and a fantastic open-plan layout, creating a bright and spacious living environment. The accommodation includes an open-plan kitchen and living area, a bathroom, double glazing, gas central heating and one allocated parking space.

Located in the popular Great Western Park development, Elm Park benefits from a range of local amenities including schools, shops, cafés, a pub and Boundary Park leisure facilities. Well placed for commuters, the area offers easy access to the A34 and a shuttle bus service to Didcot town centre and railway station.

You may be eligible for shared ownership if:

- Your household income is under £80k
- You do not own another property (or your current property is being, or about to be, sold)
- You are not married to someone who owns another property
- You have a good credit history
- You can show that you can afford the regular payments and costs involved in buying a home
- You have savings for at least a 5% deposit on the share you're buying

All prospective buyers will also need to complete a Soha affordability check with one of our panel advisors to confirm eligibility for shared ownership and affordability of the property.

- Full Market Price £220,000
- Shares Available 50% - 75%
- Currently Monthly Rent £369.90
- Current Monthly Service charge £58.75
- Current Monthly Ground Rent £8.33
- Lease Term Remaining 112 years
- EPC Rating C
- Council Tax Band B
- Allocated Parking Space



Floor Plan

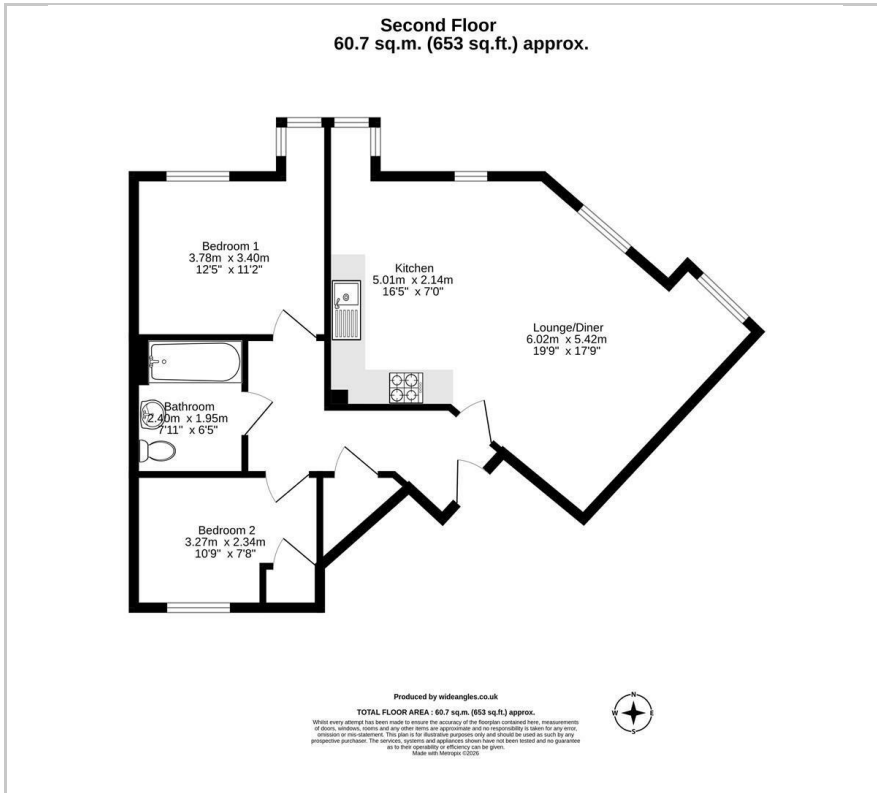

Area Map



Energy Efficiency Graph

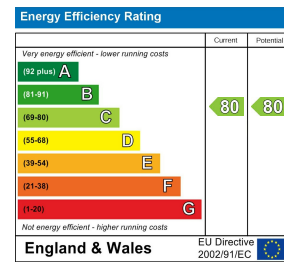

These particulars, whilst believed to be accurate are set out as a general outline only for guidance and do not constitute any part of an offer or contract. Intending purchasers should not rely on them as statements of representation of fact, but must satisfy themselves by inspection or otherwise as to their accuracy. No person in this firm's employment has the authority to make or give any representation or warranty in respect of the property.